



2018 SUMMER CLASSICS

www.milnerdowns.com

**\$60,000
in Prizes**

Featuring:

- \$ 15,000 IN FOUR HUNTER DERBIES
- \$ 5,000 GRAND PRIX
- \$ 5,000 MINI PRIX
- \$ 3,000 NEW STRIDE THOROUGHBRED JUMPER SERIES
- \$ 2,000 MY FIRST GRAND PRIX
- \$6,000 IN YOUNG HORSE CLASSES

Summer Classic I

JULY 18 – 22, 2018

Summer Classic II

JULY 25 – 29, 2018

Milner Downs Summer Classic II - July 25-29, 2018

MILNER DOWNS SUMMER CLASSIC I

Kirsten Rodel.....Maple Ridge, B.C.

Maureen Walters..... Langley, BC

Kirsten RodelMaple Ridge, B.C.

Maureen Walters.....Chilliwack, BC

USEF Competition No.331619 & 331620

FROM GRASSROOTS TO PODIUM

The Jumping Committee is the committee of Equestrian Canada responsible for all hunter, equitation and jumper activities in Canada from grassroots to the international level.



PHOTO CREDIT – Cealy Tetley

We have created a number of programs and awards to provide support for participants, recognize contributions, and promote the sport. Current Jumping programs include:



- Canadian Show Jumping Team Media Guide
- CET Medal
- JC Hall of Fame
- JC Bursary
- JC Medal
- Officials' Accessibility Fund
- Official of the Year
- Owner of the Year
- Sponsor of the Year
- Travel Assistance
- U25 Program
- Volunteer of the Year

For more information regarding Jumping programs and activities, visit: www.equestrian.ca/sport/jumping

100-308 Legget Drive | Ottawa, Ontario Canada K2K 1Y6
Telephone 613 287 1515 X101 | Toll Free 1 866 282 8395 | Fax 613 248 3484

DE LA BASE AU PODIUM

Le comité Saut d'obstacles de Canada Équestre est responsable de toutes les activités de compétition en chasse, en saut d'obstacles et en équitation, au niveau amateur comme au niveau international.



SOURCE - Cealy Tetley

Nous avons créé un éventail de programmes et de prix afin de soutenir les participants, de souligner l'engagement et de promouvoir le sport. Les programmes de Saut d'obstacles comprennent :



**EQUESTRIAN
CANADA
ÉQUESTRE**

- Guide des médias de l'équipe canadienne de saut d'obstacles
- Médaille EEC
- Panthéon du saut d'obstacles
- Bourses de Saut d'obstacles
- Médaille de Saut d'obstacles
- Fonds Accessibilité des officiels
- Officiel de l'année
- Propriétaire de l'année
- Commanditaire de l'année
- Assistance voyage
- Programme U25
- Bénévole de l'année

Pour en savoir plus sur les activités et programmes de saut d'obstacles, visitez canadaequestre.ca/sport-fr/saut-obstacles

308 prom. Legget, bureau 100 | Ottawa (Ontario) Canada K2K 1Y6
Tél 613 287 1515 X 101 | Sans frais 1 866 282 8395 | Téléc 613 248 3484

RULES & REGULATIONS

The 2018 Milner Downs Classics will be run according to the rules of Equestrian Canada. All owners, riders and trainers must be EC members. They must also be HCBC members or members of their provincial Equestrian Association. Foreign riders, owners and trainers must be members of their appropriate federation. These are EC Gold Level horse shows. Every class offered herein is covered by the rules and specifications of the current rules of EC and will be held and judged in accordance with the EC Rule Book.

MANAGEMENT

The Competition Management reserves the right to interpret all questions and conditions in regards to or arising out of or incident to the Milner Downs Classic Competitions without claims for damages or recourse of any kind. All questions not covered by these rules and regulations shall be decided by the Competition Management and their decision is final. The Competition Management reserves the right to refuse, accept conditionally, or cancel any entries, disqualify riders, exhibitors, prohibit claim damages; to change any course, to cancel or combine any unfilled competitions, after due notice to exhibitors; to change rings or rotate judges, and to change specifications in jumper competitions.

ENTRY PROCEDURE

All entries must be made in writing and signed by the owner or agent. Entries of junior riders must be signed by the parent or legal guardian. Entry fees must accompany entry form. Any horse listed "Entry" is not acceptable. One number will be assigned to each horse. Correct numbers must be worn and clearly visible at all times when riding on the grounds. No number will be issued unless all fees have been paid. A service fee of \$35.00 will be charged on all NSF cheques.

Entries received after the show has started will pay a late fee of \$50.

American exhibitors wishing to pay by cheque drawn in US funds will be charged the going rate on the date of the cheque. U.S. exhibitors wishing to pay in Canadian Funds must pay by bank draft or credit card.

ENTER ONLINE AT: www.horseshowtime.com OR

MAIL ENTRIES TO: **Milner Downs:**
21795-64th Ave., Langley, BC, V2Y 2N7

E-MAIL TO: info.milnerdowns@shaw.ca

FAX TO: (778) 278-3827

LATE ENTRIES

Entries received after Classic I and II closing date will be subject to a late entry fee of \$50.00. There will be no exceptions. Late entries should confirm the availability of stabling before travelling to the show.

ADD/SCRATCH/CHANGES

Every entry will pay a \$25.00 add/scratch/change fee. There will be no additional fee for adds made in the office in writing by 5:00pm the day before the class. Classes added the day of will be charged the cost of the class plus a \$10.00 fee per class. No adds are allowed once the class has started. In order for a full class fee refund the class must be scratched in the office before the class starts. Classes scratched at the gate only will not be refunded.

REFUNDS

- Cancellation Before Closing Date – Before closing date of entries a full refund will be given.
- Cancellation after Closing Date but before the Start of the Horse show – Stall Fees will not be refunded. Upon presentation of a Vet Slip to the entry secretary, the entry fees, exhibitor fees, and warm-up fees will be refunded, minus an office fee of \$25 or 15% whichever is greater.
- Cancellation After The Start of the Horse Show - Upon presentation of a Vet Slip to the entry secretary, class fees for the classes that have not been shown in, will be refunded minus a \$25 or 15% fee whichever is greater. Stall fee, nomination and exhibitor fees will not be refunded.

SUBSTITUTIONS

With a Veterinarian's certificate a new horse may be substituted for a scratched horse. There will be a \$25 substitution fee and all monies will be transferred to the new horse.

HORS CONCOURS

EC Article G201.3. No horse or pony will be allowed to show "hors concours" in any hunter or equitation or divisions.

EC Article G501

1. "Hors Concours" entries may be accepted at the competition committee's discretion but are subject to the same rules as a regular entry. Hors Concours may not participate in any jump-off.
2. A horse or pony that has competed "Hors Concours" is not permitted to be judged in the same ring on the same day. A horse or pony may only compete "Hors Concours" once in the same ring on the same day.

DRUG FEES

Drug fees of \$ 7.00 will be collected for every horse entered.

BARN BILLS / TRAINER SPLITS

Trainers requiring barn bills should set them up at the beginning of the horse show with a credit card or open cheque. Trainer splits must be done by no later than Saturday.

PRIZES:

Prize for winner of all classes. Ribbons to 8th place. Prize money will be divided as follows: 1st - 30%, 2ND - 23%, 3RD - 15%, 4TH - 12%, 5th - 10%, 6th - 10%. unless otherwise noted. Prizes for the Champion & Reserve Champion in each division. Prize money will be mailed within 30 days of the close of the competition.

STABLING

Stall locations will be posted the Monday of each show week. Absolutely NO STALL CHANGES allowed without the approval of the show office and show manager. Stabling at \$170 per stall for the duration of the show, is available and will be assigned on a first-come basis. There is limited stabling available for horses. There are also a limited number of stalls in the main barn at \$ 195 per stall. Some tack stalls may be available. There is a mandatory \$85 per horse charge for unlimited use of shavings. Stall doors are provided.

HORSE RECORDING

Horse Recordings are mandatory for all horses and ponies entering EC sanctioned competitions. Horses must be entered under the name and with the same owner as appearing on the Horse Recording. (A402)EC sanctioned competitions require the following (where applicable): An active Horse Recording or EC National Passport (with active Horse Recording component). USEF horses may compete with a valid USEF Horse Recording Number. Persons responsible for US or other foreign-owned/leased horses competing in EC Sanctioned Competitions must complete an affidavit stating that their horse(s) are eligible to compete as entered and must declare the jumper registration number(s) that have been assigned by their respective national federation. If a Horse Recording or an EC National Passport cannot be produced, the person responsible must complete a Temporary Horse Registration form and pay the temporary registration fee. Results achieved while competing with a Temporary Horse Registration may not be used to qualify for year-end awards, championship competitions, finals or subsequent competitions requiring qualification. In the case of ponies six years or over, the owner must enter a statement as to whether the pony is small, medium or large and this must also be signed and dated. Regarding pony measurement, refer to Chapter A11, Measurement, and discipline/breed sport rules. For ponies under six, see Article A1104, Temporary Measurement Forms. Where applicable, the pony measurement section must be completed. Temporary pony measurement forms must be in the possession of the owner/lessee and available to competition management or stewards.

MEMBERSHIPS

At all Milner Downs Competitions all competitors, and owners and trainers must have a valid individual sport license with Equestrian Canada & Provincial membership or be members of their own National Equestrian Federation. A copy of these memberships must be submitted with entries.

ENTERED & DID NOT COMPETE

Any exhibitor who does not compete in a class in which the exhibitor is officially entered, and does not scratch according to the scratch procedures outlined above will be billed for the classes. You **MUST** do your paperwork in the Show Office in order to avoid this penalty.

PROTECTIVE HEADGEAR

At all EC sanctioned competitions, anyone mounted on a horse on the competition grounds, including foreign competitors, must wear approved helmets with safety harness correctly fastened, at all times. Juniors showing any horse in a jog for soundness must wear approved protective headwear with the attached safety harness fastened.

HAUL-IN FEE:

There will be a \$25 a day charge per horse for haul-in.

NON SHOWING FEE

There will be a non showing fee \$50 for horses not entered in any classes at the competition. The non showing fee allows use of the warm-up rings and other grounds as well as access to the rings on warm-up day. All non showing horses are required to sign an entry waiver and wear a number.

WARMUPS

Schooling rounds will be available over a posted course in the sand hunter and jumper ring 2 at a cost of \$10.00 per round.. Heights will be at specific times.

The Ashley Reber Field will not be available for schooling

Clear round schooling will be available in the Grand Prix field.

SCHOOLING & WARM UP RULES

All Equestrian Canada sanctioned competitors are required to use current FEI schooling rules as listed. Refer to Chapter 8, FEI rules, Article 201, and Annex 1 - Exercise and Schooling Areas and Practice Obstacles. These rules pertain to all hunter, equitation, and jumper classes and divisions at all EC sanctioned competitions. a) Use of coloured sheets over the take-off side or under a properly constructed obstacle is permitted. b) Flags on fences in the schooling areas are at the discretion of the EC steward on duty. c) In Equitation and Hunter competitions and schooling rings, plastic cups or FEI breakaway track systems with adaptors are required. Steel pins are not acceptable. See Article G116. d) Hunter Schooling only: Ground Lines- A ground line may be used on both sides of an oxer if the top rails are not ramped. If the oxer is ramped, the back ground line must be removed. Top rails may not be offset. General Oxer Rules: Square- both back and front rails of an oxer are equal height, back and front ground lines allowed. Offset- the back rail of an oxer is lower than the front rail, illegal. Ramped- the back rail of an oxer is higher than the front rail, legal if back ground line is removed. e) If a Liverpool is being used lengthwise for schooling, the total length of the Liverpool may not exceed 1.80 meters. If a Liverpool is used in the competition ring, an additional one (or reasonable substitution) supplied by the OC must be available in the schooling area. A reasonable substitution would be a yoga mat or similar. No tarpaulins are permitted.

CONFLICTS

With the exception of the Junior Hunters, riders are not limited to how many horses they may ride per class. If a rider foresees a scheduling problem they need to consult the Competition Manager or Technical Coordinator. Management's decision will be final. In the event a rider has multiple horses (no more than 2) remaining at the end of a class, both horses should be in the vicinity of the ring and the rider will be given 5 minutes to warm up and enter the ring with each horse. If the horses are not in the warm-up area, the judge will be instructed to pin the class.

CONCUSSION

Accidents & Return to Play rule: In the event of a fall/accident where a concussion can be reasonably suspected, the competitors must receive medical clearance by qualified medical personnel onsite before continuing to compete. The competitor is solely responsible for ensuring the onsite medical assessment takes place. Should a competitor refuse to be evaluated, they will be disqualified from the competition. If onsite qualified medical personnel suspect a concussion or believe the competitor may be at risk of concussion due to the nature of the fall or impact, the competitor will be suspended from competition and placed on a Medical Suspension List until medically released. Competitors will remain on the EC Medical Suspension List until they submit an EC Return to Play Form, signed by a licensed physician, to EC. No competitor shall compete at EC sanctioned competitions while on the EC Medical Suspension List and competition organizers may refuse entry to anyone currently on the list.

RING DIMENSIONS

RING	FOOTING	SIZE
Ashley Reber Hunter	Grass	350' x 300'
Hunter II	Sand	320' x 110'
Grand Prix	Grass	500' x 250'
Jumper II	Grass	330' x 330'

DOGS

All dogs must be on a leash on the show grounds. Absolutely no dogs in schooling area or show arenas at any time.

MOTORIZED VEHICLES

Minors who do not have a valid driver's license which allows them to operate a motorized vehicle in the province or state in which they reside will not be permitted to operate a motorized vehicle of any kind, including, but not limited to, golf carts, motorcycles, scooters, or farm utility vehicles, on the competition grounds of licensed competitions. Minors who have a valid temporary license may operate the above described motorized vehicles as long as they are accompanied by an adult with a valid driver's license. ***The parent(s), legal guardians(s), or individual who signs the entry blank as a parent or guardian of a minor operating a motorized vehicle in violation of this rule are solely responsible for any damages, claims, losses or actions resulting from that operation.*** Violations of this rule will be cause for sanctions against the parent(s), guardian(s) and/or trainer(s) who are responsible for the child committing the offense. Penalties may include exclusion of the child, parent(s), guardian(s), and/or trainer(s) from the competition grounds for the remainder of the competition and charges being filed against any of the above individuals in accordance with Chapter 6. Wheelchair and other mobility assistance devices for individuals with disabilities are exempt from this rule.

ACCOMMODATION

Limited camper and trailer parking is available adjacent to the show grounds. Please contact the show office for reservations.

CREDIT CARDS

Visa and MasterCard accepted.

EQUESTRIAN CANADA STATEMENT OF PRINCIPAL

Equestrian Canada (EC), the national equestrian federation of Canada, supports adherence to humane treatment of horses in all activities under its jurisdiction. EC is committed to: Upholding the welfare of the horses, regardless of value, as a primary consideration in all activities; Requiring that horses be treated with kindness, respect and the compassion that they deserve, and that they never be subjected to mistreatment; Ensuring that owners, trainers and exhibitors or their agents use responsible care in the handling, treatment and transportation of their horses as well as horses placed in their care for any purpose; Providing for the continuous well-being of horses by encouraging routine inspection and consultation with health care professionals and competition officials to achieve the highest possible standards of nutrition, health, comfort and safety as a matter of standard operating procedure; Continuing to support scientific studies on equine health and welfare; Requiring owners, trainers and exhibitors to know and follow their sanctioning organization's rules, and to work within industry regulations in all equestrian competition; Reviewing, revising and developing competition rules and regulations that protect the welfare of the horses. The standard by which conduct or treatment will be measured is that which a person, informed and experienced in generally accepted equine training and exhibition procedures, would determine to be neither cruel, abusive, nor inhumane.

EQUESTRIAN CANADA ENTRY AGREEMENT

By entering either of the Milner Downs Summer Classics listed in this prize list, and by signing the entry forms as owner, lessee, trainer, manager, agent, coach, driver, handler, and on behalf of myself and my principal, representatives, employees and agents, I agree that I am subject to the Bylaws and Rules of EC and the local rules of the competition. I agree to be bound by the Bylaws and rules of Equestrian Canada. I will accept as the final decision of the Hearing Committee on any question arising and the Rules, and agree to release and hold harmless the competition, Equestrian Canada, their officials, directors and employees for any actions taken under the Rules I represent that I am eligible as enter and/or participate under the rules, and every horse I am entering is eligible as entered. Competitors agree that as a condition of and in consideration of acceptance of entry, Equestrian Canada and/or the competition may use photographs, videos, audios, cable casts, or other likenesses of the competitor and horse taken during the course of the competition for the promotion, coverage of benefit of the competition sport. Those likenesses shall not be

used to advertise a product and they may not be used in such a way as to jeopardize Amateur status. Competitions waive and release rights in connection with such use, including any claim to compensation, invasion of privacy, right of publicity or to misappropriation. Per Article A801, every entry at an EC sanctioned competition shall constitute an agreement by the person responsible that the owner, lessee, trainer, manager, agent, coach, driver or rider and horse shall be subject to the EC constitution and all rules of EC and any additional rules set by the competition. It is the responsibility of all individuals participating in any capacity in EC sanctioned competitions to be knowledgeable regarding the EC constitution the applicable rules of EC and the additional rules, if any, imposed by the competition. Do not participate in this EC sanctioned competition in any capacity if you do not consent to be bound by the constitution and rules of EC and any additional rules imposed by the competition.

USEF ENTRY AGREEMENT AND MEMBERSHIP STATEMENT

By entering a Federation-licensed Competition and signing this entry blank as the Owner, Lessee, Trainer, Manager, Agent, Coach, Driver, Rider, Handler, Vaultor or Longeur and on behalf of myself and my principals, representatives, employees and agents, I agree that I am subject to the Bylaws and Rules of The United States Equestrian Federation, Inc. (the "Federation") and the local rules of Thunderbird Show Park. I agree to be bound by the Bylaws and Rules of the Federation and of the competition. I will accept as final the decision of the Hearing Committee on any question arising under the Rules, and agree to release and hold harmless the competition, the Federation, their officials, directors and employees for any action taken under the Rules. I represent that I am eligible to enter and/or participate under the Rules, and every horse I am entering is eligible as entered. I also agree that as a condition of and in consideration of acceptance of entry, the Federation and/or the Competition may use or assign photographs, videos, audios, cable - casts, broadcasts, internet, film, new media or other likenesses of me and my horse taken during the course of the competition for the promotion, coverage or benefit of the competition, sport, or the Federation. Those likenesses shall not be used to advertise a product and they may not be used in such a way as to jeopardize amateur status. I hereby expressly and irrevocably waive and release any rights in connection with such use, including any claim to compensation, invasion of privacy, right of publicity, or to misappropriation. The construction and application of Federation rules are governed by the laws of the State of New York, and any action instituted against the Federation must be filed in New York State. See GR908.4. Federation Release, Assumption of Risk, Waiver, and Indemnification This document waives important legal rights. Read it carefully before signing. I AGREE in consideration for my participation in this Competition to the following: I AGREE that the "Federation" and "Competition" as used herein includes the Licensee and Competition Management, as well as all of their officials, officers, directors, employees, agents, personnel, volunteers and Federation affiliates. I AGREE that I choose to participate voluntarily in the Competition with my horse, as a rider, driver, handler, vaultor, longeur, lessee, owner, agent, coach, trainer, or as parent or guardian of a junior exhibitor. I am fully aware and acknowledge that horse sports and the Competition involve inherent dangerous risks of accident, loss, and serious bodily injury including broken bones, head injuries, trauma, pain, suffering, or death. ("Harm"). I AGREE to hold harmless and release the Federation and the Competition from all claims for money damages or otherwise for any Harm to me or my horse and for any Harm of any nature caused by me or my horse to others, even if the Harm arises or results, directly or indirectly, from the negligence of the Federation or the Competition. I AGREE to expressly assume all risks of Harm to me or my horse, including Harm resulting from the negligence of the Federation or the Competition. I AGREE to indemnify (that is, to pay any losses, damages, or costs incurred by) the Federation and the Competition and to hold them harmless with respect to claims for Harm to me or my horse, and for claims made by others for any Harm caused by me or my horse while at the Competition. I have read the Federation Rules about protective equipment, including GR801 and, if applicable, EV114, and I understand that I am entitled to wear protective equipment without penalty, and I acknowledge that the Federation strongly encourages me to do so while WARNING that no protective equipment can guard against all injuries. If I am a parent or guardian of a junior exhibitor, I consent to the child's participation and AGREE to all of the above provisions and AGREE to assume all of the obligations of this Release on the child's behalf I represent that I have the requisite training, coaching and abilities to safely compete in this competition. I AGREE that if I am injured at this competition, the medical personnel treating my injuries may provide information on my injury and treatment to the Federation on the official USEF accident/injury report form. Life, senior active and junior active members shall be eligible to participate in all classes at Regular Competitions, Eventing Competitions at the Preliminary Level or above and Combined Driving Competitions at the Advanced Level, Dressage, Reining and Vaulting Competitions and Endurance Rides. A nonmember may participate as a handler, rider, driver, owner, lessee, agent, coach or trainer at Regular Competitions, Eventing Competitions, Dressage Competitions, Reining Competitions and Combined Driving Competitions upon payment of a \$30 Show Pass fee. Participants in the following classes are exempted from the Requirements of this rule: 1) leadline; 2) exhibitions; 3) games and races; 4) classes for 4-- H members; 5) walk trot and academy classes (academy classes are classes limited to horses used regularly in a lesson program); 6) USDF introductory level tests, pas de deux and quadrille classes; 7) NRHA Endorsed Reining Competitions. 8) Opportunity classes, 9) citizens of other nations who have proof, in English, of current membership in good standing of their own National Federation, 10) USEA beginner novice division; and 11) assistant handlers in Dressage Sport Horse Breeding classes.

USEF EQUINE VACCINATION RULE

As per USEF GR845 horses must be accompanied by documentation of Equine Influenza Virus and Equine Herpes Virus (Rhinopneumonitis) vaccinations issued within six months prior to entering the showgrounds. Horses not in compliance with this rule may be required to leave the competition grounds upon request by Competition Management. Please provide your Vaccine Records to the Show Office upon entering as checks will be done.

CONDITION OF ENTRY

As a condition of acceptance of entry, exhibitors give Milner Downs Equestrian Centre an irrevocable right and permission to publish, market, transfer, assign, or otherwise make use of any photographs, likeness, films, broadcasts, audiotapes or videotapes taken of the horse(s) and Exhibitors while on the grounds, so long as the use does not jeopardize amateur status. Exhibitors further expressly and irrevocably waive and release any rights in connection with such use of photographs, likenesses, films, broadcasts, audiotapes, or videotapes, including any claims for invasion of privacy, right of publicity, misappropriation, or libel.

LIABILITY

All owners and competitors and trainers are personally responsible for damages to persons caused by themselves, their employees, their agents or their horses. The owners and competitors and trainers MUST have third party insurance to provide full coverage for participation in equestrian events at any of the 2017 Milner Downs Summer Classics. Neither Milner Downs Equestrian Centre (2005) Ltd. nor Milner Downs Holdings Ltd., nor their organizing committee, board of directors, sponsors, employees, volunteers nor contractors shall be in any way liable for any accident, injury, death, damage, loss or any other matter that may happen, from any causes or circumstances whatsoever to competitors, exhibitors, or members of their family or their agents, or to any animal or article exhibited or to any property brought on to Milner Downs property, or for any other loss, claim, matter, circumstance or event whatsoever in connection with or arising out of or attributable to any of the Milner Downs Summer Classic Horse Shows.

BIO-SECURITY

Protecting the health of your horses is of the utmost importance to Milner Downs. In addition to the Required Horse Health Requirements for Vaccination and Event Participation Declaration, Milner has compiled this list of Bio-Security Measures that are excellent guidelines for decreasing the risk of exposure or spread of disease.

Direct and Indirect Contact Between Horses and People:

The most common path for spreading germs and disease is contact among horses, humans and other animals. Bodily fluids such as nasal discharge, saliva and sweat can carry germs which are easily transmitted from horse to horse through direct and indirect contact.

~ Limit horse-to-horse contact

~ Limit horse-to-human-to-horse contact

~ Limit horse-to-dog (other animal)-to horse, or horse-to-dog-to-human-to-horse contact.

1. Loose dogs will not be tolerated. Loose dogs in the stabling area, competition area, ship-in area, or found anywhere on the show grounds will be detained. \$50 fine for the first offense, \$100 for the second, and so on. Multiple offenses may result in expulsion from the grounds. *Dogs can be a leading cause of the spread of germs – horses nuzzle the dog, people pet the dog then pet the next horse – and before you know it, the germs have been spread. Please be courteous and clean up after you dogs on the grounds – Milner Downs will have doggie bags and cans available around the grounds.*

2. Restrict unnecessary movement of horses out of their aisle or barn. Don't take a horse to another barn to be tacked up, braided, clipped, etc. *It may seem easier sometimes, but sharing equipment and grooming supplies, or coming into nose-to-nose contact with other horses or soiled surfaces can spread germs.*

3. Do not lead horses down other tent/barn aisles. Don't cut through a tent/barn on your way to the paddock or ring; go around the perimeter of the tent/barn. *It may be shorter, but it risks your horse coming into to contact with other horses, soiled surfaces and equipment, dogs, etc.*
4. Don't let horses make nose-to-nose contact with horses from other barns when in common areas such as wash racks, at the rings, or while grazing. *Yes, it's cute when they want to visit with each other, but germs can spread just like the cold or flu going through a kid's classroom.*
5. Do not touch or pet, or feed treats to horses from other barns unless necessary. *Yes, we all want to pet all the horses we see, but be mindful that you may be spreading germs from one horse to another when you do this.*

Equipment Handling:

Soiled equipment is another common path for spreading germs and disease. Nasal discharge, saliva, sweat, and even soiled bedding can carry microbes and spread them via shared items such as tack, equipment, hoses, buckets, grooming supplies and towels.

1. Do not let water hoses touch buckets when filling. Contact with a contaminated surface on a water bucket can be easily transmitted to the next bucket contacted.
2. Do not allow horses to drink from the hose.
3. Do not share water or feed buckets.
4. Have hand sanitizer readily available, and use it between grooming/tacking up horses. Keep it handy in the grooming stall, on your golf cart, and in your grooming box at the ring
5. Use clean brushes and towels on each horse. If you don't have enough brushes for each horse to have his own set, be sure to wash them often.
6. Don't share tack and equipment, especially bits and bridles, unless they are cleaned between each use.
7. Monitor your horses & contact Paton & Martin Ass. , the Show Veterinarian, at (604) 856-3351 if you notice any unusual symptoms.

Protecting the health of your horses is of the utmost importance to Milner Downs. Milner Downs has implemented Required Bio-Security Measures to decrease the risk of introduction and/or spread of contagious or infectious disease at its show. The following Health Requirements must be on file in the Horse Show Office for ALL horses entering the Show Grounds, both Showing and Non-showing. Competition numbers will not be issued until the requirements are met.

Health Requirements:

1. Proof of Vaccination

You must provide proof of vaccination for ALL of your horses on the grounds, showing or not

Required Vaccines are: EHV 1 & 4 (Rhino) – within 6 months (180 Days)

2. Event Participation Form

You must complete the Event Participation Form, available in the Office, at www.milnerdowns.com or in the prize list.

3. Back Numbers will not be issued until the Health Requirements are met. Milner Downs may require any horse with missing/incomplete/expired Vaccination Records to be placed under observation until the requirements are met.

4. Keep copies of your Vaccination records in your tack room or in your truck/trailer. You may be asked by Milner personnel or to present your health papers at any time.

5. Ship-Ins: If you ship in and out daily, keep copies of your Vaccination records in your truck/trailer. You may be asked to present these records. The Ship-in lot will be checked daily. If proper records are not immediately available, the horse(s) must a.) remain under Milner Staff observation until the paperwork is presented, or b.) will be asked to leave the grounds.

6. Ship-ins may ONLY park in the designated areas; Ship-ins MAY NOT park by the barns.

Bio-Security Measures:

1. Be sure to read the Bio-Security tips on the reverse of this page – a one-page handout that reviews simple steps we all can take to keep horses healthy!

2. Trainers - please let your braider know to about the new Bio-Security regulations.

Thanks for showing with us!
Milner Management

◆ HUNTERS ◆

INDIVIDUAL STAKE CLASSES MAY NOT BE ENTERED – Must have shown in one other class over fences

ArtG201.3 No horse or pony will be allowed to show "hors concours" in any hunter classes or divisions.

LOW HUNTER

\$30 per Class

Low Trot Pole - 536,541,519

Low 2'0" – 520,534,539,544,547

Low 2'6 - 505, 506, 507, 508, 509

Low 3'3"- 530,533,549,540,518

Low X-Rail – 537,542,545

Low Training Pony – 521,535

Low 2'9 -510, 511, 512, 500.532,

Low 3'6" – 522,523,524,525,531

Low 18" - 538,543,546

Low 2'3 - 501, 502, 503, 504,548

Low 3'0 - 513, 514, 515, 516, 517

Low Pony – 526,527,528,529

PRE-GREEN HUNTER

A Pre-green hunter is a horse of any age in his first or second year of showing over fences at 3' or higher at an EC-sanctioned competition. A 1st Year Pre-Green horse is in his first year of showing over fences at 3' or higher and a 2nd Year Pre-Green horse is in his second year of showing over fences at 3'0 or higher at an EC-sanctioned competition. A 1st Year Pre-Green horse has never competed over fences of 3' or higher prior to January 1 of the current year at an EC-sanctioned competition. A 2nd Year Pre-Green horse has never competed over fences higher than 3'3 prior to Jan 1 of the current year at an EC-sanctioned competition. No Pre-Green Hunter may jump 3'6 or higher without jeopardizing their Green status.

FIRST YEAR PRE-GREEN – 3'0"

\$35 per class.

100. Pre-Green Hunter

101. Pre-Green Hunter

102. Pre-Green Hunter

103. **\$100** Pre-Green Hunter Stake

104. Pre-Green Hunter under saddle

SECOND YEAR PRE-GREEN – 3'3"

\$35 per class.

100. Pre-Green Hunter

101. Pre-Green Hunter

102. Pre-Green Hunter

103. **\$100** Pre-Green Hunter Stake

104. Pre-Green Hunter under saddle

PERFORMANCE HUNTER 3'3

Open to all horses and riders.

Fences 3'3"

\$35 per class

105. Performance Hunter

106. Performance Hunter

107. Performance Hunter Stake

108. **\$100** Performance Hunter Stake

109. Performance Hunter u/s

PERFORMANCE HUNTER 3'6

Open to all horses and riders.

Fences 3'6"

\$35 per class

110. Performance Hunter

111. Performance Hunter

112. Performance Hunter Stake

113. **\$100** Performance Hunter Stake

114. Performance Hunter u/s

COMBINED HUNTER

State on your entry blank whether the horse is 1st, 2nd, or a Regular Hunter.

First Year Jump 3'6" Second Year Jumper 3'9" Regular Jump 3'9"

\$35 per class

115. Combined Hunter

116. Combined Hunter

117. Combined Hunter

118. **\$100** Combined Hunter Stake

119. Combined Hunter under saddle

JUNIOR HUNTER 3'3"

\$35 per class

- 120. Junior 3'3" Hunter
- 121. Junior 3'3' Hunter
- 122. Junior 3'3" Hunter
- 123. **\$100** Junior 3'3 Hunter Stake
- 124. Junior 3'3" Hunter under saddle

AMATEUR OWNER 3'3"

\$ 35 per class

- 125. Amateur Owner 3'3" Hunter
- 126. Amateur Owner 3'3" Hunter
- 127. Amateur Owner 3'3" Hunter
- 128. **\$100** Amateur Owner 3'3" Hunter Stake
- 129. Amateur Owner 3'3" Under Saddle

JUNIOR WORKING HUNTER

Open to all junior riders. No cross entry into Children's Hunter. Fences to 3'6".

\$35 per class

- 130. Junior Working Hunter 3'6"
- 131. Junior Working Hunter 3'6"
- 132. Junior Working Hunter 3'6"
- 133. **\$100** Junior Working Hunter Stake
- 134. Junior Working Hunter under saddle

AMATEUR OWNER WORKING HUNTER

Open to amateur riders. Fences 1.10m (3'6")

\$35 per class

- 135. Amateur Owner Working Hunter
- 136. Amateur Owner Working Hunter
- 137. Amateur Owner Working Hunter
- 138. **\$100** Amateur Owner Working Hunter Stake
- 139. Amateur Owner Working Hunter under saddle

PONY HUNTER

Open to all ponies ridden by junior riders. Adults are permitted to be judged on large ponies in miscellaneous non-point classes not limited to juniors and adult amateurs. Adults amateurs may ride large ponies in adult amateur classes where fences do not exceed 3'0". A pony judged with an adult rider may not be judged in classes with a junior rider at the same competition, Juniors of any age may show any height of pony in miscellaneous non-point classes.

Fences 2'3"(S) 2'6" (M) 2'9" (L)

\$35 per class

- 200. Pony Hunter
- 201. Pony Hunter
- 202. Pony Hunter
- 203. **\$100** Pony Hunter Stake
- 204. Pony Hunter under saddle

CHILDREN'S HUNTER

Open to all horses ridden by junior riders. Children's riders may not cross enter into any hunter or equitation class with fences over 3'3 and jumper fences over 1m.

\$35 per class. Fences 3'0 (0.90m)

- 140. Children's Hunter
- 141. Children's Hunter
- 142. Children's Hunter
- 143. **\$100** Children's Hunter Stake
- 144. Children's Hunter under Saddle

ADULT AMATEUR HUNTER

Open to all horses ridden by amateur riders. Adult Amateur riders may not cross enter into any hunter or equitation class with fences over 3'3" and jumper fences over 1.0m".

\$35 per class. Fences 3'0 (0.90m)

- 145. Adult Amateur Hunter
- 146. Adult Amateur Hunter
- 147. Adult Amateur Hunter
- 148. **\$100** Adult Amateur Hunter Stake
- 149. Adult Amateur Hunter under saddle

MODIFIED CHILD / ADULT HUNTER Not Rated for EC Awards

Open to all junior/amateur riders. Fences 2'9".

\$35 per class

- 150. Modified Child/Adult Hunter
- 151. Modified Child/Adult Hunter
- 152. Modified Child/Adult Hunter
- 153. **\$100** Modified Child/Adult Hunter Stake
- 154. Modified Child/Adult Hunter under saddle

TRAINING PONY Not rated for EC Awards

Adults are permitted to be judged on large ponies in miscellaneous non-point classes not limited to junior and adult amateurs where fences do not exceed 3'0". A pony judged with an adult may not be judge in classes with a junior at the same competition.

\$35 per class

- 211. Training Pony
- 212. Training Pony
- 213. Training Pony
- 214. Training Pony
- 215. Training Pony under saddle

SHORT STIRRUP PONY HUNTER Not Rated for EC Awards

This division is designed for beginner junior pony riders. No cross entry rider with any class or division over 2'9" 0.85m at this horse show. Riders may not cross entry into rated pony division. Ponies not restricted.

\$35 per class Fences 2'3 – no oxers

- 216. Short Stirrup Pony Hunter
- 217. Short Stirrup Pony Hunter
- 218. Short Stirrup Pony Hunter
- 219. Short Stirrup Pony Hunter
- 220. Short Stirrup Pony Hunter under saddle

SHORT / LONG STIRRUP HUNTER Not Rated for EC Awards

This division is designed for beginner junior and amateur riders. No cross entry rider with any class or division over 2'9" 0.85m at this horse show. Horses and ponies not restricted. Distances will not be changed for ponies.

\$ 35 per class Fences 2'3" - No Oxers

- 221. Short/Long Stirrup Hunter
- 222. Short/Long Stirrup Hunter
- 223. Short/Long Stirrup Hunter
- 224. Short/Long Stirrup Hunter
- 225. Short/Long Stirrup Hunter under saddle

PRE-CHILDREN'S HUNTER Not Rated for EC Awards

Open to junior riders. Riders may not cross enter into any hunter classes over 2'9" or any jumper classes over 3'0". Horses not restricted.

\$35 per class Fences 2'6"

- | | |
|-----------------------|------------------------------------|
| 226. Pre-Child Hunter | 229. Pre-Child Hunter |
| 227. Pre-Child Hunter | 230. Pre-Child Hunter under saddle |
| 228. Pre-Child Hunter | |

PRE-ADULT HUNTER Not Rated for EC Awards

To be ridden by an adult amateur. Rider may not cross enter into any hunter classes over 2'9" or any jumper classes over 3'0". Horses not restricted.

\$35 per class Fences 2'6".

- 231. Pre-Adult Hunter
- 232. Pre-Adult Hunter
- 233. Pre-Adult Hunter
- 234. Pre-Adult Hunter
- 235. Pre-Adult Hunter under saddle

BABY GREEN HUNTER Not Rated for EC Awards

Open to all horses in their first year of showing. No Cross entry with any class over 2'9".

Fences to 2'6".

\$35 per class

- | | |
|------------------------|-------------------------------------|
| 236. Baby Green Hunter | |
| 237. Baby Green Hunter | 239. Baby Green Hunter |
| 238. Baby Green Hunter | 240. Baby Green Hunter under saddle |

TROT POLE HUNTER (Not Rated for EC Awards)

Open to either horses or riders in their first or second year of showing at EC shows.

Classes intended for beginner horses or riders.

\$30 per Class

- | | |
|-----------------------|--------------------------------|
| 241. Trot Pole Hunter | 245. Trot Pole Under Saddle |
| 242. Trot Pole Hunter | 246. Trot Pole Equitation o/f |
| 243. Trot Pole Hunter | 247. Trot Pole Equitation Flat |
| 244. Trot Pole Hunter | |

X-RAIL HUNTER (Not Rated for EC Awards)

Open to either horses or riders in their first or second year of showing at EC shows.

Classes intended for beginner horses or riders.

\$30 per Class

- | | |
|--------------------|-----------------------------|
| 248. X-Rail Hunter | 252. X-Rail Hunter u/s |
| 249. X-Rail Hunter | 253. X-Rail Equitation o/f |
| 250. X-Rail Hunter | 254. X-Rail Equitation Flat |
| 251. X-Rail Hunter | |

18" HUNTER (Not Rated for EC Awards)

Open to all horses/ponies/riders who have not shown over 2'0 at this horse show.

\$ 30 per Class

- 205. 18" Hunter
- 206. 18" Hunter
- 207. 18" Hunter
- 208. 18" Hunter
- 209. 18" Hunter u/s

MILNER DOWNS 2'0" HUNTERS (Not Rated for EC Awards)

Open to all horses, ponies and riders.

\$35 per class

- | | |
|------------------------|--|
| 255. Milner 2'0 Hunter | 259. Milner 2'0 Hunter u/s |
| 256. Milner 2'0 Hunter | 260. Milner 2'0 Hunter Equitation |
| 257. Milner 2'0 Hunter | 261. Milner 2'0 Hunter Equitation Flat |
| 258. Milner 2'0 Hunter | |

MILNER DOWNS 2'6" LOW HUNTERS Not Rated for EC Awards

Open to all horses, ponies and riders.

\$35 per Class

- | | |
|----------------------------------|----------------------------------|
| 262. Milner Downs Low Hunter 2'6 | 265. Milner Downs Low Hunter 2'6 |
| 263. Milner Downs Low Hunter 2'6 | 266. Milner Downs Low Hunter u/s |
| 264. Milner Downs Low Hunter 2'6 | |

SCHOOLING HUNTER 2'3 Not Rated for EC Awards

Open to all horses, ponies and riders.

\$35 per Class

- | | |
|---------------------------|-------------------------------|
| 267. Schooling 2'3 Hunter | 270. Schooling 2'3 Hunter |
| 268. Schooling 2'3 Hunter | 271. Schooling 2'3 Hunter u/s |
| 269. Schooling 2'3 Hunter | |

SCHOOLING HUNTER 2'0 Not Rated for EC Awards

Open to all horses, ponies and riders.

\$35 per Class

- | | |
|---------------------------|-------------------------------|
| 272. Schooling 2'0 Hunter | 275. Schooling 2'0 Hunter |
| 273. Schooling 2'0 Hunter | 276. Schooling 2'0 Hunter u/s |
| 274. Schooling 2'0 Hunter | |

SMALL WORKING HUNTER Not Rated for EC Awards

\$35 per Class

Open to horses up to and including 16.0 hands.

- | | |
|---------------------------|-------------------------------|
| 155. Small Working Hunter | 158. Small Working Hunter |
| 156. Small Working Hunter | 159. Small Working Hunter u/s |
| 157. Small Working Hunter | |

LARGE WORKING HUNTER (Not Rated for EC Awards)

\$35 per Class

Open to Horses over but not including 16.0 hands.

- | | |
|---------------------------|-------------------------------|
| 160. Large Working Hunter | 163. Large Working Hunter |
| 161. Large Working Hunter | 164. Large Working Hunter u/s |
| 162. Large Working Hunter | |

SCHOOLING HUNTER 2'9" Not Rated for EC Awards

Open to all horses, ponies and riders. Fences 2'9"

\$35 per class

- | |
|-------------------------------|
| 165. Schooling Hunter 2'9 |
| 166. Schooling Hunter 2'9 |
| 167. Schooling Hunter 2'9 |
| 168. Schooling Hunter 2'9 |
| 169. Schooling Hunter 2'9 u/s |

EQUITATION & MEDAL CLASSES

No horse or pony will be allowed to show "hors concours" in any equitation or medal class.

Entry Fee \$30 per class unless otherwise noted

400. "A" Equitation Fences – 3'6	
401. "A" Equitation Flat	415. Pony Equitation Flat
402. "B" Equitation Fences – 3'0	416. Adult Equitation Fences 3'0
403. "B" Equitation Flat	417. Adult Equitation Flat
404. "C" Equitation Fences – 3'0	418. Child 14-under Eq Fences 3'0
405. "C" Equitation Flat	419. Child 14-under Eq Flat
406. Child 15-17 Eq Fences 3'0	420. Jump Canada Medal - \$35
407. Child 15-17 Eq Flat	421. CET Medal 3'6-3'9 - \$35 entry
408. 18" Equitation O/F	422. CET Mini 3'3 - \$35 entry
	423. 18" Equitation Flat
410. Pre-Child Eq Fences 2'6	260. Milner 2'0" Equitation O/F
411. Pre-Child Eq Flat	261. Milner 2'0" Equitation Flat
412. Pre-Adult Eq Fences 2'6	253. X-Rail Equitation O/F
413. Pre-Adult Eq Flat	254. X-Rail Equitation Flat
428. Mod Ch/Ad Eq 2'9	427. Pony Equitation Fences
429. Mod Ch/Ad Eq 2'9 Flat	246. Trot Pole Equitation O/F
432. Short/Long Stirrup Eq Flat	247. Trot Pole Equitation Flat
431. Short/Long Stirrup Eq Fences	436. BCHJA 3'3 Jr/Am Hunt Seat Medal

901. PLATINUM PERFORMANCE USEF TALENT SEARCH

Entry Fee \$35

Minimum of 6 riders to complete the course to fill.

Current membership required. Open to junior young riders who are members of the USET and USEF and have not reached their 21st birthday. Competitors must use the same horse in both phases.

A water jump, liverpool or a jump simulating water will be used in the jumper phase. At "AA" rated outdoor competitions, a water-filled obstacle with a 10' (3.05m) to 12' (3.30m) spread (with or without a pole) must be included. **At all other rated competitions a liverpool is required.**

The jumping phase of the class shall be held first over a course of at least ten fences 3'7" – 3'9" (1.10 – 1.15m) in height with spreads to 4'11" (1.50m). Each course must contain no fewer than 3 fences set at 3'9" in height and none lower than 3'6". The course will include a double and triple combination or 3 doubles.

At least 12 riders, if available, must be called back for the flat phase.

All riders must ride in the jumping phase, which will be offered first and will constitute entry into the class as a whole, regardless of whether the rider is called back for the second, flat phase.

902. ASPCA MACLAY MEDAL

Entry Fee \$35

Minimum of 6 riders to complete the course to fill.

Open to junior riders who have not yet reached their 18th birthday. Rider and trainer must be current members of the ASPCA/HNSSA and must show their ASPCA numbers on the entry form.

903. PESSOA/USEF HUNTER SEAT MEDAL

Entry Fee \$35

Minimum of 3 riders to complete the course to fill.

Open to junior active members of the USEF who have not yet reached their 18th birthday. To be shown over a course of not less than eight obstacles at 3'6", which must include 1 combination including an oxer and 2 changes of direction after 1st obstacle.

◆ HUNTER CLASSICS ◆

Shown over two rounds. The second round will be over a shortened course. The top 10 horses are to come back in reverse order of placing. Both rounds judged on the point system. Final placing based on the accumulated standings over the 2 rounds.

300. \$400 PATON & MARTIN VETERINARY CHILDREN'S / ADULT HUNTER CLASSIC

Open to any rider/horse combination that has competed in the Children's or Adult Hunter division at this show.

Entry Fee: \$45

Fences 3'0"

◆ Cooler to Winner – Prize Money to 6th Place ◆

301. \$100 PONY HUNTER CLASSIC

Open to any pony that has competed in a Pony Hunter Division at this show.

Entry Fee: \$40

Fences as per EC heights

◆ Prize to Winner – Prize Money to 6th Place ◆

302. \$100 SHORT/LONG STIRRUP HUNTER CLASSIC

Open to any horse/pony/rider combination that has competed in the Short Stirrup Pony/Short/Long Stirrup Hunter division at this show.

Entry Fee: \$40

Fences 2'3".

◆ Prize to Winner – Prize Money to 6th Place ◆

303. \$100 PRE-CHILD/ADULT HUNTER CLASSIC

Open to any horse/rider combination that has competed in either the Pre-Child Hunter or Pre-Adult Hunter division at this show.

Entry Fee: \$40

◆ Prizer to Winner – Prize Money to 6th Place ◆

304. \$100 MODIFIED CHILD/ADULT CLASSIC

Open to any horse/rider combination that has competed in the Modified Child/Adult Hunter Division at this show.

Entry Fee: \$40

◆ Prizer to Winner – Prize Money to 6th Place ◆

305. \$100 MILNER DOWNS 2' CLASSIC

Open to any horse/rider combination that has competed in at least 2 classes at 2'0" or below at this show.

Entry Fee: \$40

◆ Prizer to Winner – Prize Money to 6th Place ◆

◆ HUNTER DERBIES ◆

The Hunter Derbies are a hunter competition and the horses are being judged on performance, hunter pace and style, quality and substance, movement and brilliance. Obstacles will simulate those reminiscent of the hunt field. Derby style jumps offered could be; natural post and rail, stone wall, white board fence or gate, coop, aiken, hedge, oxer, brush, logs, natural foliage.

Class 306

\$5,000 MILNER DOWNS HUNTER DERBY (Classic I)

306A - 3'3" & 306B - 3'6"

Part of the Canadian Hunter Derby Series.

Will be judged as one class. Two heights will be offered – 3'3" and 3'6". Open to all riders that have shown in at least one Hunter class at the show. No horse or rider cross entry with Class #307A or 307B. One Round.

Nomination Fee: \$50

Start Fee: \$200

◆ Cooler to Winner – Ribbons & Prize Money to 8th Place ◆

\$1,500•\$1,000•\$800•\$500•\$400•\$300•\$250•\$250

Class 307

\$2,500 JUNIOR/AMATEUR HUNTER DERBY (Classic I)

307A - 3'0" & 307B - 3'3"

Fences 3'0" / 3'3" Riders choose which height to ride and the competition will be judged as one class.

First round will be run as a "Classic" round and pinned to the top 8 highest scores. The Top 12 Riders will be invited back for a 2nd round over a Handy type course.

Second round will be run as a Handy Round and have option jumps:
3'0 Height will have 3'3" with options
3'3 Height will have 3'6" with options

Following the 2nd round the overall combined scores from the 2 rounds will be awarded.

Open to all Junior & Amateur riders. Must have competed in at least one Hunter class at the show. Scores will be announced after each round.

No horse or rider cross entry with class # 306A or 306B.

Nomination Fee: \$25

Start Fee: \$150

◆ Cooler to Winner – Ribbons & Prize Money to 8th Place ◆

\$750•\$450•\$300•\$250•\$200•\$200•\$175•\$175

Class 308

\$5,000 HUNTER DERBY (Classic II)

308A - 3'3" & 308B - 3'6"

Part of the Canadian Hunter Derby Series.

Fences 3'3" and 3'6". Open to any horse/rider combination that has shown in at least one Hunter class at the show. No horse or rider combination cross entry with Class #309A or 309B. One Round.

Nomination Fee: \$50

Start Fee: \$200

♦ Cooler to Winner – Ribbons & Prize Money to 8th Place ♦
\$1,500•\$1,000•\$800•\$500•\$400•\$300•\$250•\$250

Class 309

\$2,500 JUNIOR/AMATEUR HUNTER DERBY (Classic II)

309A - 3'0" & 309B - 3'3"

Fences 3'0" / 3'3" Riders choose which height to ride and the competition will be judged as one class.

First round will be run as a "Classic" round and pinned to the top 8 highest scores.
The Top 12 Riders will be invited back for a 2nd round over a Handy type course.

Second round will be run as a Handy Round and have option jumps:
3'0 Height will have 3'3" options
3'3 Height will have 3'6" options

Following the 2nd round the overall combined scores from the 2 rounds will be awarded.

Open to all Junior & Amateur riders. Must have competed in at least one Hunter class at the show. Scores will be announced after each round.

No horse or rider cross entry with class # 308A or 308B

Nomination Fee: \$25

Start Fee: \$150

♦ Cooler to Winner – Ribbons & Prize Money to 8th Place ♦
\$650•\$500•\$390•\$200•\$150•\$110



**New Stride Thoroughbred Adoption Society
\$3,000 Thoroughbred Hunter Classic Series**

Milner Downs Classic I • July 18th – 22nd

**CLASS #900 - NEW STRIDE THOROUGHbred ADOPTION SOCIETY JUMPER
CHALLENGE SERIES**

Sponsored by: Austeville Properties

Prize Money \$1,500

Class Specifications: Open to all Thoroughbreds with valid tattoo or papers from The Jockey Club or CTHS. Copy of the papers must be provided to the Show Office or tattoo verified by a Vet. Choice in 2 heights will be offered (0.75m & 0.90m). Horse/Rider combination will jump their chosen height in both rounds. The Class will be run in an immediate jump off format (FEI Art 238 Table A2.2). Winner will receive a cooler.

Featuring \$500 East-West Series Challenge Bonus for top point Thoroughbred of 2018

Milner Downs Classic II • July 25th – 29th

**CLASS #900 - NEW STRIDE THOROUGHbred ADOPTION SOCIETY JUMPER
CHALLENGE SERIES**

Sponsored by: Austeville Properties

Prize Money \$1,500

Class Specifications: Open to all Thoroughbreds with valid tattoo or papers from The Jockey Club or CTHS. Copy of the papers must be provided to the Show Office or tattoo verified by a Vet. Choice in 2 heights will be offered (0.75m & 0.90m). Horse/Rider combination will jump their chosen height in both rounds. The Class will be run in an immediate jump off format (FEI Art 238 Table A2.2). Winner will receive a cooler.



Prize money to be split

30% • 22% • 15% • 10% • 7% • 6% • 5% • 5%

ENTRY FEE: \$ 120

\$6,000 YOUNG HORSE CLASSES

For 2018 we are pleased to add 6 YOUNG HORSE CLASSES each with \$1,000 in Prize Money. These young horse classes are intended to showcase developing horses.

There will be one clear round class (Table A 238.1.1) tentatively scheduled for Wednesday in the Grand Prix Ring.

Please present Horse Recording Number or registration papers showing proof of age and breeding information with entry form to the Competition Office. Horses born after October 1 of the calendar year are eligible to compete in the age category of the next year. Open to all riders and both EC and USEF/ USHJA horses.

Time allowed will be determined by the course designer. The 4 & 5 Year Olds will be judged in the following manner: 50% on jumping style, way of going and future potential and 50% on performance. Faults will result in -4 points from performance score, time faults: -1 from performance score. The 6 year olds will return for a jump off, run according to Table A Article 238.2.2.

Boot check will be performed upon completion of each individual round. Please see Art.257.2.4.

Entry Fee: \$ 90 per class

- | | | | |
|------|----------|---------------|-----------------|
| 910. | \$ 1,000 | Four Year Old | - 0.90m - 1.00m |
| 911. | \$ 1,000 | Five Year Old | - 1.00m - 1.10m |
| 912. | \$ 1,000 | Six Year Old | - 1.10m - 1.20m |

Prize Money to 6th & Ribbons to 8th Place

\$300.\$230.\$150.\$120.\$100,\$100

◆ JUMPERS ◆

Nominated Rings

Horses entered in the Grand Prix Ring pay a nomination fee of \$75. Jumper nomination fees are non-refundable.

Late Jumper Nomination Fee

Horses not nominated by the closing date of entries for the show must pay a nomination fee of \$125.

Jumper Nominating Fee Refund Policy

Jumper Nomination fee refund schedule as follows: before the closing date of entries – 100%, after the closing date, but before the start of the show – 50%. After the show starts there will be no refunds.

Footing

All Jumper Classes will be on grass.

Hor Concour rule as per Art G501.1

Schooling

Clear Round Jumper in the Grand Prix Ring & Jumper II will have ticketed round warm up.

Numbers must be worn at all times.

Individual Stake Classes and Classics/Derbies may not be entered. You must have entered and shown in at least one other class in that division.

JUMPER RIDERS ARE REMINDED OF THE EC RULE: A HORSE / RIDER / JR/AM/NON PRO COMBINATION IS PERMITTED UNLIMITED UPWARD MOVEMENT, BUT DOWNWARD MOVEMENT IS RESTRICTED TO ONLY ONE LEVEL. THESE MOVEMENTS ARE BASED ON THE LEVEL OF THE 1ST CLASS IN WHICH THEY COMPETED.

CLEAR ROUND

Classes \$20 each

- 1 /2 - Clear Round 1.00m
- 3 /4 Clear Round 1.10m
- 5/6 – Clear Round 1.15m

7/8 Young Horse

1.00m JUMPERS

Open to all horses and riders.

Fences 3'3 (1.00m)

- 600. \$100 1.00m Jumper – Start Fee \$40
- 601. \$100 1.00m Jumper – Start Fee \$40
- 602. \$100 1.00m Jumper – Start Fee \$40
- 603. \$250 1.00m Jumper Stake – Start Fee \$45

1.00m JUNIOR/AMATEUR JUMPER

Open to all horses and Junior/Amateur riders.

Fences 3'3 (1.00m)

- 604. \$100 Jr/Am 1.00m Jumper – Start Fee \$40
- 605. \$100 Jr/Am 1.00m Jumper – Start Fee \$40
- 606. \$100 Jr/Am 1.00m Jumper – Start Fee \$40
- 607. \$250 Jr/Am 1.00m Jumper Stake – Start Fee \$ 45

1.10m JUMPERS

Open to all horses and riders.

Fences to 3'6 (1.10m)

- 608. \$100 1.10m Jumper – Start Fee \$40
- 609. \$100 1.10m Jumper – Start Fee \$40
- 610. \$100 1.10m Jumper – Start Fee \$40
- 611. \$100 1.10m Jumper – Start Fee \$40

JUNIOR/AMATEUR/ Non Pro 1.10m JUMPERS

Open to all junior/amateur riders.

Fences to 3'6 (1.10m)

- 612. \$100 1.10m Jr/Am Jumper – Start Fee \$40
- 613. \$100 Jr/Am 1.10m Jumper – Start Fee \$40
- 614. \$100 Jr/Am 1.10m Jumper – Start Fee \$40
- 615. **\$400** Jr/Am 1.10m Stake – Start Fee \$50

1.15m JUMPERS

Open to all horses and riders.

Fences to 3'9 (1.15m)

- 616. \$100 1.15m Jumper – Start Fee \$40
- 617. \$100 1.15m Jumper – Start Fee \$40
- 618. \$100 1.15m Jumper – Start Fee \$40
- 619. \$100 1.15m Jumper – Start Fee \$40

JUNIOR/AMATEUR 1.15m JUMPER

Open to all junior/amateur riders.

Fences 3'9 (1.15m)

- 620. \$100 Jr/Am 1.15m Jumper – Start Fee \$40
- 621. \$100 Jr/Am 1.15m Jumper – Start Fee \$40
- 622. \$100 Jr/Am 1.15m Jumper – Start Fee \$40
- 623. \$ 100 Jr/Am 1.15 Jumper – Start Fee \$40

*MILNER DOWNS IS PLEASED TO ANNOUNCE THE "RUNNING FOX SADDLE SERIES".
HORSE/RIDER COMBINATIONS WILL COMBINE SCORES/TIMES IN THE 1.20M
CLASSES AND THE LOWEST SCORE/TIME WILL RECEIVE A LUC CHILDERIC SADDLE.*

1.20m JUMPERS – Sponsored by: Running Fox

Open to all horses and riders.

Fences 4'0 (1.20m)

624. \$100 1.20m Jumper – Start Fee \$40

625. \$200 1.20m Jumper – Start Fee \$40

626. \$1,000 1.20m Jumper – Start Fee \$ 100

***Running Fox Saddle Challenge Point Class**

627. \$300 1.20m Jumper – Start Fee \$50

1.20m Jr/Am JUMPERS

628. \$100 1.20 Jr./Am. Jumpers – Start Fee \$40

629. \$100 1.20 Jr./Am. Jumpers – Start Fee \$40

630. \$100 1.20 Jr./Am. Jumpers – Start Fee \$40

631. \$100 1.20 Jr./Am. Jumpers – Start Fee \$50

1.30m JUMPERS

Open to all horses and riders.

Fences to 4'3 (1.30m)

632. \$100 1.30m Jumper – Start Fee \$40

633. \$100 1.30m Jumper – Start Fee \$40

634. \$200 1.30m Jumper – Start Fee \$45

635. \$300 1.30m Jumper – Start Fee \$50

MILNER DOWNS MINI PRIX'S – Classic I

*Must have shown in one other jumper competition at the show to be eligible.

Start Fees: \$55

636. \$500 Mini Prix 1.00m

637. \$500 Mini Prix 1.10m

638. \$500 Mini Prix 1.15m

JUMPER DERBIES – Classic II

The competitions will be run Derby Style from the Grand Prix Ring into Jumper Ring 2.

*Must have shown in one other competition to be eligible.

Start Fees: \$55

639. \$500 Jumper Derby 1.00m

640. \$500 Jumper Derby 1.10m

740. \$2,000 Jr/Am "MY FIRST GRAND PRIX" (Classic II)

Sponsored by "Molly's Folly"

Jump Off run as " Match The Clock"

Must have competed in one class in the .90 Jr/Am Division during the show.

Start Fee: \$150

♦ **Cooler to Winner – Prize Money to 6th & Ribbons to 8th Place** ♦

\$650•\$500•\$390•\$200•\$150•\$110

650. \$5,000 GRAND PRIX – Classic I

Sponsored by: Tempest Aviation Group

Open to all horses and riders nominated to the Grand Prix Ring. Horse & Rider combination must have competed in at least one class at the respective heights to qualify. Must indicate what height you will jump on your entry form.

Nomination Fee: \$50

650A. 1.00m – Start Fee: \$225

650B. 1.10m – Start Fee: \$225

650C. 1.15m – Start Fee: \$225

650D. 1.20m – Start Fee: \$225

♦ **Cooler to Winner – Ribbons & Prize Money to 8th Place** ♦

\$1,300•\$1,000•\$800•\$700•\$400•\$300•\$250•\$250

651. \$5,000 GRAND PRIX – Classic II

Fences 1.20m – 1.25m

Nomination Fee: \$50

Start Fee: \$225

♦ **Cooler to Winner – Ribbons & Prize Money to 8th Place** ♦

\$1,300•\$1,000•\$800•\$700•\$400•\$300•\$250•\$250

♦ JUMPER RING 2 ♦

PLEASE NOTE: Classes in Jumper Ring 2 may be entered by Division or Individual class fee. In order to go in the Classic you must have shown in one other class of the division. All Jumper Classes \$35 each unless otherwise noted.

.65m OPEN JUMPERS

Open to all horses and riders.

Fences to .65m

700. .65 Open Jumper

701. .65 Open Jumper

702. .65 Open Jumper

703. .65 Open Jumper

.65m JUNIOR/AMATEUR JUMPER

Open to all Jr./Am riders

704. .65 Jr./Am Jumper

705. .65 Jr./Am Jumper

706. .65 Jr./Am Jumper

707. .65 Jr./Am Jumper

.75M OPEN JUMPERS

Open to all horses and riders.

Fences to 0.75m

- 708. .75 Open Jumper
- 709. .75 Open Jumper
- 710. .75 Open Jumper
- 711. .75 Open Jumper

.75 JUNIOR/AMATEUR JUMPER

Open to all junior/amateur riders

Fences to 0.75m

- 712. .75 Jr./Am Jumper
- 713. .75 Jr./Am Jumper
- 714. .75 Jr./Am Jumper
- 715. .75 Jr./Am Jumper

.85 OPEN JUMPERS

Open to all horses and riders.

Fences 0.85m

- 716. .85 Open Jumper
- 717. .85 Open Jumper
- 718. .85 Open Jumper
- 719. .85 Open Jumper

.85 JUNIOR/AMATEUR JUMPER

Open to all junior/amateur riders

Fences to 0.75m

- 720. .85 Jr./Am Jumper
- 721. .85 Jr./Am Jumper
- 722. .85 Jr./Am Jumper
- 723. .85 Jr./Am Jumper

PONY JUMPERS

Open to all ponies. Fences 0.90m

- 724. Pony Jumper
- 725. Pony Jumper
- 726. Pony Jumper
- 727. Pony Jumper

0.90m OPEN JUMPERS

Open to all horses and riders.

Fences to 0.90m

- 728. 0.90m Open Jumper
- 729. 0.90m Open Jumper
- 730. 0.90m Open Jumper
- 731. 0.90m Open Jumper

0.90m JUNIOR/AMATEUR JUMPERS

Open to all junior/amateur riders.

Fences to 3'0 (0.90m)

- 732. .90 Jr./Am Jumper
- 733. .90 Jr./Am Jumper
- 734. .90 Jr./Am Jumper
- 735. .90 Jr./Am Jumper

JUMPER CLASSIC

Entry Fee: \$ 50

Open to all horse /rider combinations that have shown in at least one class in the division of the classic height you wish to enter.

- 736. \$ 300 .65m Jumper Classic
- 737. \$ 300 .75m Jumper Classic
- 738. \$ 300 .85m Jumper Classic
- 739. \$ 300 .90m Jumper Classic

SOCIAL EVENTS

MILNER DOWNS SUMMER CLASSIC I

- Wednesday* - *Welcome Party*
- Thursday* - *\$3,000 in Young Horse Classes*
 - *&*
 - *Milner Downs Dog Show*
- Friday* - *\$5,000 3'3'/3'6 Open Hunter Derby &*
 - *\$2,500 Jr/Am Hunter Derby*
 with Dinner on the Bank
- Saturday* - *\$5,000 Milner Grand Prix*
 - *Modified 2'9" Child/Adult Hunter Classic*
 - *\$1,500 New Stride Thoroughbred Jumper Challenge*
- Sunday* - *\$1,500 in Mini Prixs!!!*

MILNER DOWNS SUMMER CLASSIC II

- Wednesday - Welcome Party*
- Thursday - \$3,000 in Young Horse Classes*
- BEACH DAY – Wear your Beach Cloths – riders too
- Friday - \$5,000 Hunter 3'3/3'6" Open Hunter Derby &*
- \$2,500 Jr/Am Hunter Derby
with Dinner on the Bank
- Saturday - \$5,000 Grand Prix with Party on the Deck!*
- \$1,500 New Stride Thoroughbred Jumper Challenge
- Sunday - \$1,000 in Jumper Derbies!!!*

MAP TO MILNER DOWNS

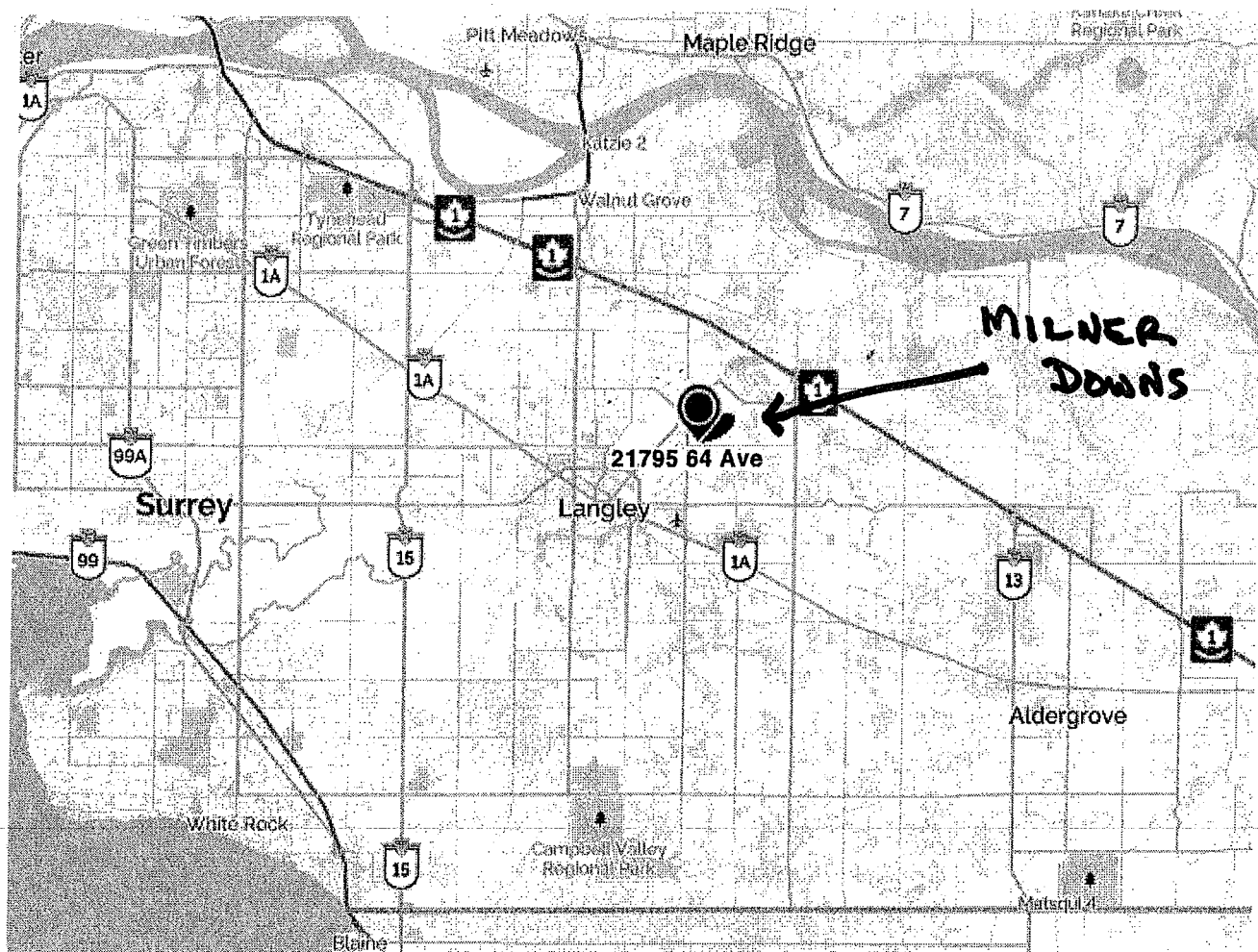

DIRECTIONS TO MILNER DOWNS:

1. Proceed west on Hwy # 1;
2. Take 232 South Exit;
3. Over Freeway, keep right and road becomes Hwy # 10; go for 3 km;
4. Left at Glover Road; go for 2 km;
5. Left onto 216th Street; go for ½ km;
6. Left into Milner Downs.

MILNER DOWNS EQUESTRIAN CENTRE

21795 64TH AVE.

LANGLEY, B.C.

Telephone 604-534-7918